

DASH NO.	M CODE	MADE FROM
----------	--------	-----------

GSD

KC-59-485

REVISIONS

ISSUE	CHANGES
5	CN 33778 E REDRAWN KH 06/15/92

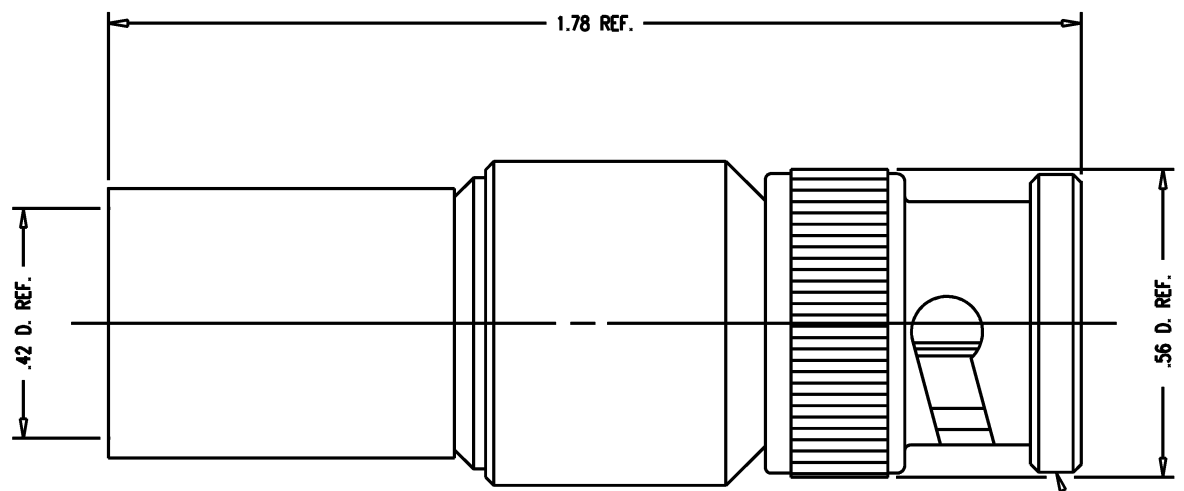

NOTES:

1. FOR USE WITH BELDEN 8213 & 9292 CABLE.
2. FOR CABLING INSTRUCTIONS SEE CP-5402.
3. FOR CABLE TRIMMING USE KTJ-150 & KTD-138.
4. FOR CRIMPING USE DIE KTH-2004.
5. INTERFACE PER MIL-STD-348, FIG. 301-1.
6. CENTER CONTACT TO BE SUPPLIED UNASSEMBLED.
7. MATERIALS:
 INSULATOR: TEFLON, ASTM-D-1457
 K-GRIP SLEEVE: COM. BRONZE, ALLOY 220
 GASKET: SILICONE RUBBER, ZZ-R-765
 SPRING WASHER: BER. COPPER, ASTM-B-196
 ALL OTHER METAL PARTS: BRASS, ASTM-B16
8. FINISHES:
 SPRING WASHER: SILVER PLATE, QQ-S-365
 CENTER CONTACT: HARD GOLD PLATE, PER MIL-G-45204
 ALL OTHER METAL PARTS: KINGS TARNISH RESISTANT FINISH (TR-5)
9. ELECTRICAL CHARACTERISTICS:
 NOMINAL INPEDANCE: 50 OHMS
 WORKING VOLTAGE: 500 VRMS
 FREQUENCY RANGE: DC TO 4 GHz

STAMP: KINGS KC-59-485

KAM2068

SCALE 4:1

APPROX SURFACE AREA

USED ON

REF:

PLUG, BNC

DRAWN KH	DATE 06/15/92
----------	---------------

DESIGN LI	DATE 06/16/92
-----------	---------------

APPR.	DATE
-------	------

KINGS
ELECTRONICS CO., INC.
TUCKAHOE, NEW YORK 10707

KC-59-485

GSD